



Welcome to Building Great Neighbourhoods Inglewood Neighbourhood Renewal

Working together to make the most out of your neighbourhood.

This is your city and your neighbourhood. We want to understand how you experience your neighbourhood and ask for your input on what we might do to make it better. We will engage and work with you on the renewal of roads, sidewalks, streetlights and park spaces, and promote other community opportunities to enhance how people live and interact in your neighbourhood. We commit to being open and transparent about how your input is used. Let's make the most out of your neighbourhood.

Edmonton

Neighbourhood Renewal Project Vision and Important Elements

Inglewood Neighbourhood Vision

Inglewood is a safe and walkable neighbourhood. It is welcoming to everyone, and brings people together through fun, community-building activities. It reflects its diversity and connection to Indigenous history.

Inglewood Neighbourhood Important Elements

- A safe neighbourhood supported by lighting and visibility.
- A walkable neighbourhood, supported by accessibility, traffic management and safe crossing and pathways.
- Common spaces that are functional and have amenities to support fun and community building activity for people of all ages and backgrounds.
- Visual representation of the neighbourhood's diversity, including Indigenous heritage.

How We Got Here

All project decisions, including the preparation of the preliminary plans, are based on: public input, technical requirements and City policies and programs, including available funding.

From winter 2017 to today, we have actively invited input into Inglewood's Neighbourhood Renewal.

The Inglewood Public Engagement timeline highlights these milestones.

Today we are asking you to review Inglewood's preliminary plans and ADVISE us on anything we need to consider before proceeding with construction.

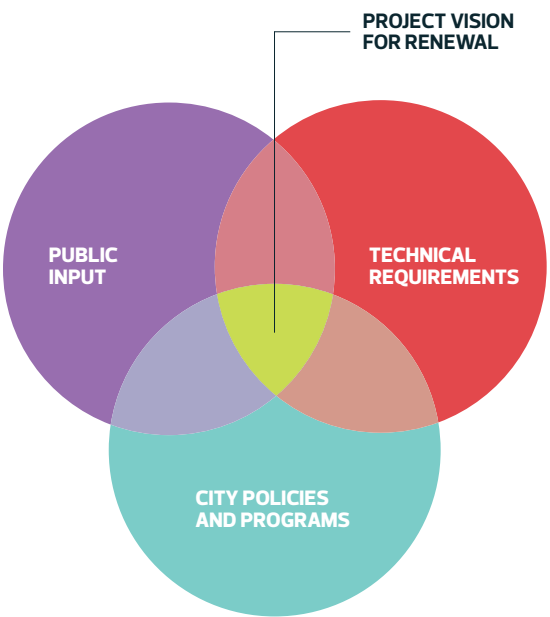

Technical Requirements:

- Infrastructure Assessments
- Complete Streets Design and Construction Standards
- Universal Design
- Crime Prevention Through Environmental Design
- Urban Design Framework

City Policies and Programs:

- City's Strategic Plans – The "Ways"
- Active Transportation Policy (Sidewalk Strategy; Bicycle Transportation Plan)
- Local Improvement Policy
- Public Engagement Policy
- Breathe – Green Network Strategy
- Winter City Guidelines
- Vision Zero
- Community Traffic Management Policy

Inglewood Public Engagement Timeline

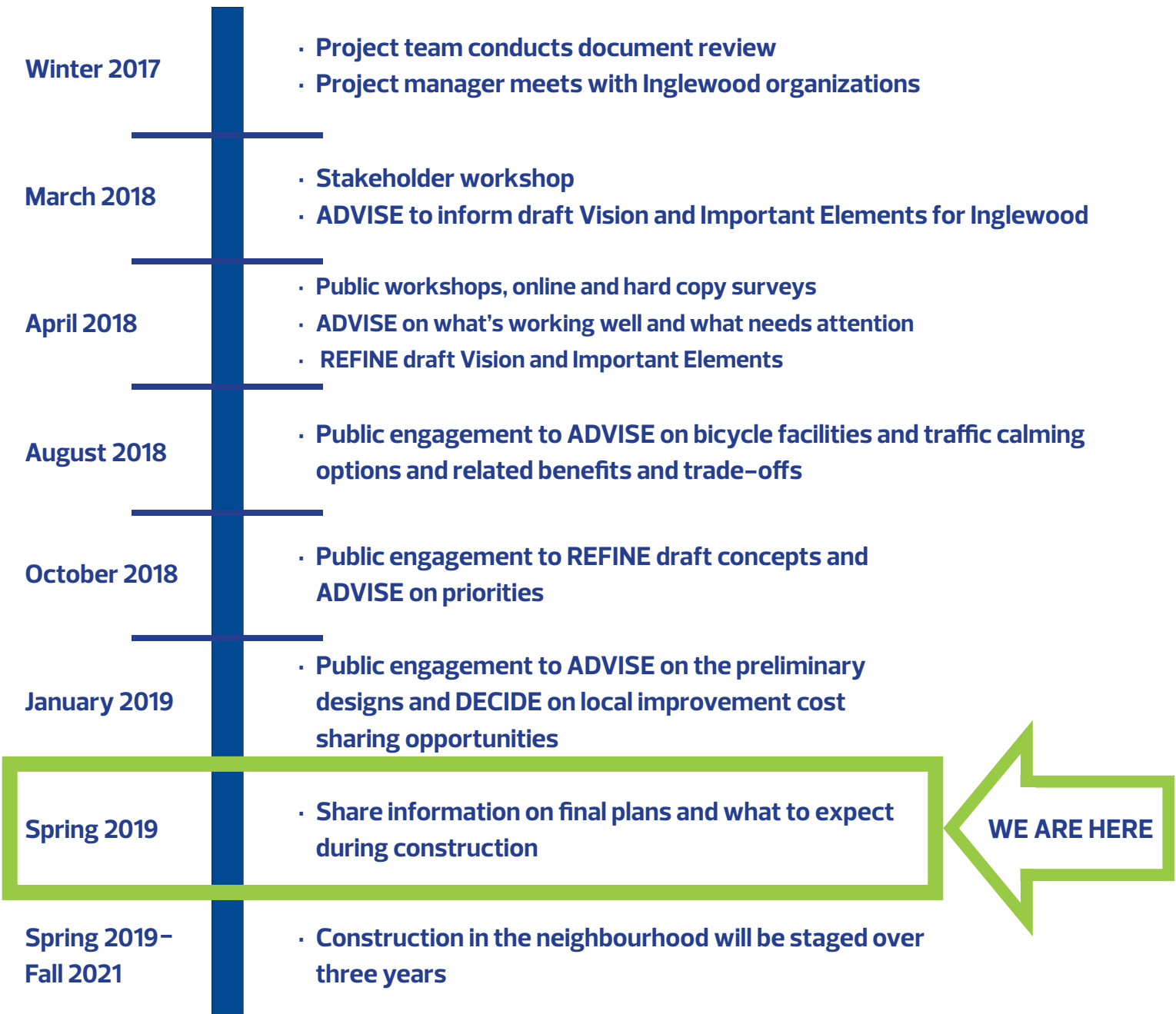

John A. Norris Park

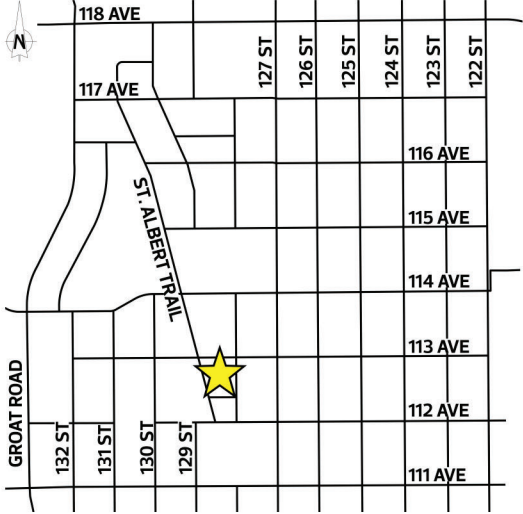

Bench Style

*Preliminary Designs – subject to funding, potential detail design changes and approval



Linear Park



Linear Park North Segment

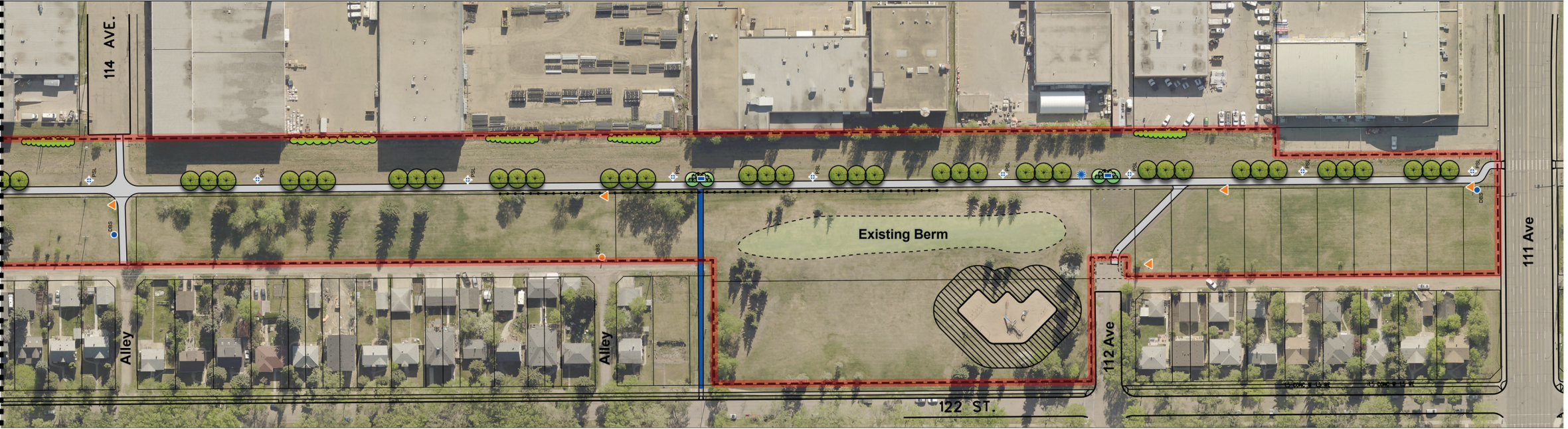
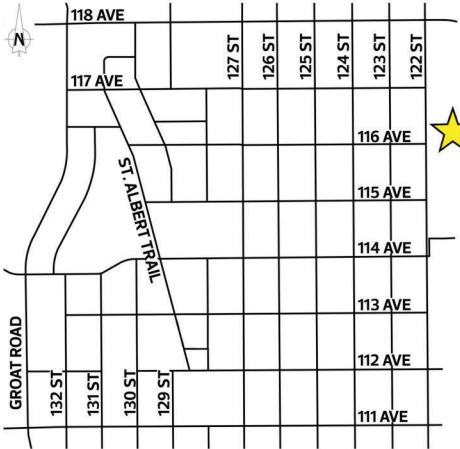

Linear Park South Segment

LEGEND

| Existing | Proposed |
|----------|--|
| | Chainlink Fence |
| | Dog Off-Leash Boundary (Excludes Playground) |
| | Dog On-Leash Area (10m Around Playground) |
| | Waste Receptacle |
| | Dog Bag Dispenser |
| | Shared Use Path |
| | Bench |
| | Interpretive Sign |
| | Deciduous Shade Tree |
| | Ornamental Tree |
| | Ornamental Shrubs |
| | Naturalized Planting Bed*** |
| | Light Standard (Subject to Change) |
| | Seating Area |
| | Seating Area Enlargement (Not Shown on Plan) |

*Preliminary Designs – subject to funding, potential detail design changes and approval.
** Off-Leash physical boundary (i.e. fence or planting) to be considered for future project development.
***Naturalized Planting Beds are subject to change based on utility locations. To be planted by others following the renewal of Linear Park)

Showcasing Heritage and Character

The City is exploring the following ways to showcase Inglewood's heritage and character, including its connection to Indigenous history:

- Updates to the existing monument on 127 Street (south of 115 Avenue), which currently tells the story of:
 - Inglewood: A Historical Guide
 - The Camsell Mosaic
 - Park Street Bikeway Route Map
 - Inglewood: A Tribute to the People
- Create and install interpretive signage that tells the story behind the park, including its namesake, historical use of the land, and the relationships that led to developments in the Inglewood Area in:
 - John A. Norris Park
 - Linear Park
- Replacement of historic street name bricks with decorative street blades that feature the historic street name for better year-round visibility and durability
 - Community has opportunity to determine decorative street blade design within City standards
 - For more information, please connect with your Community League



114 Avenue Shared Use Path

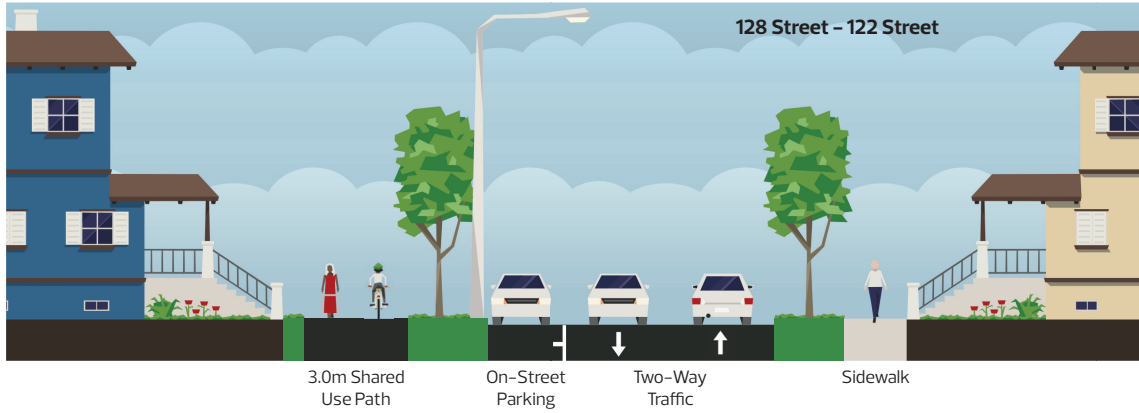
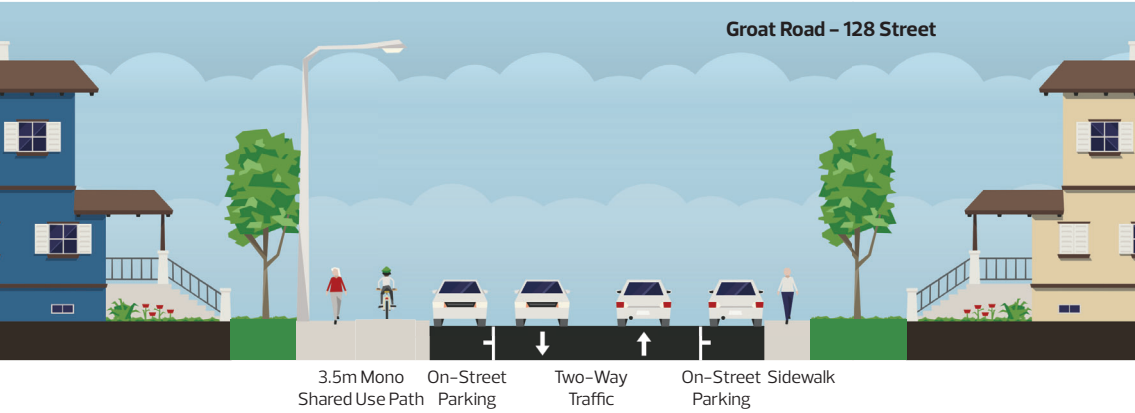
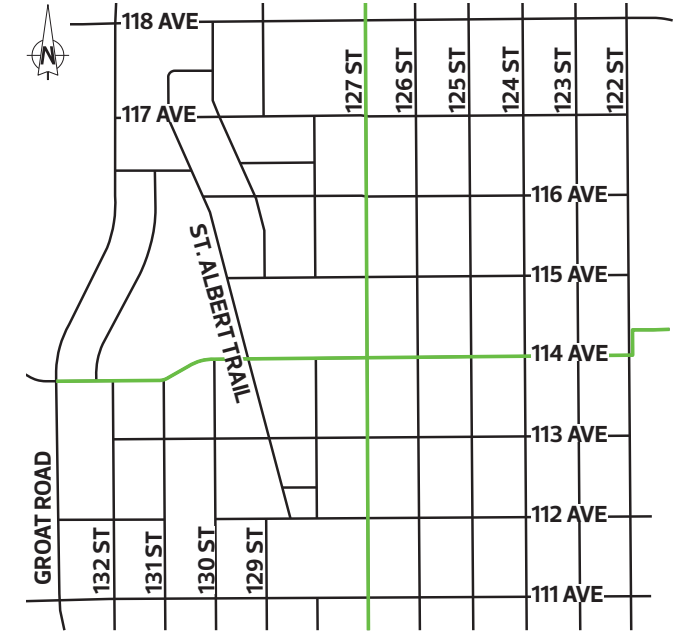
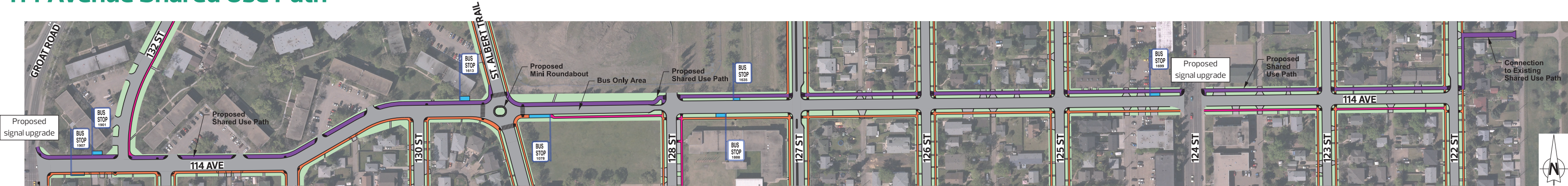

127 Street Bike Route Improvements

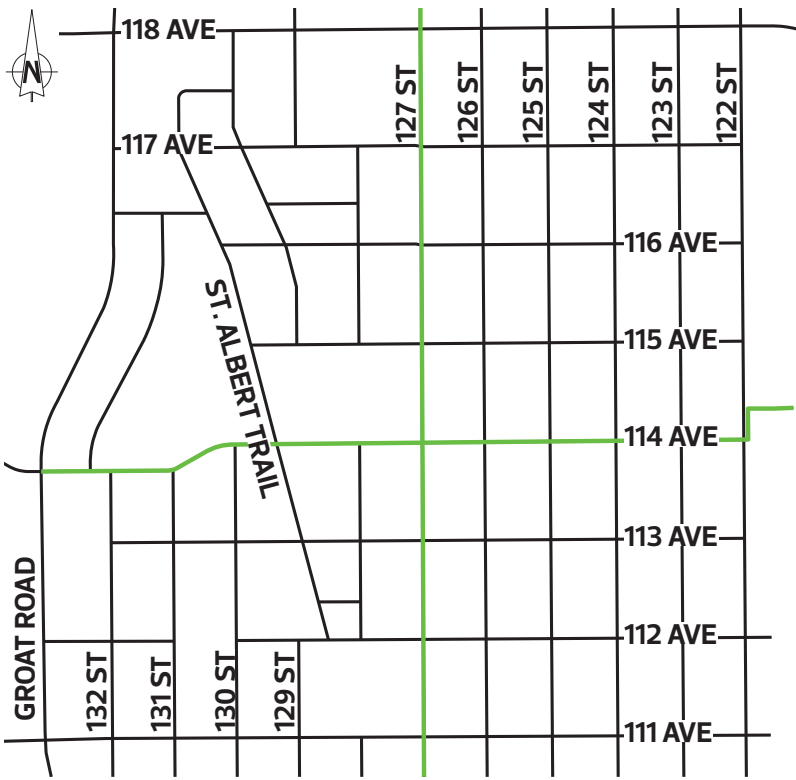

Example Intersection Signage Layout

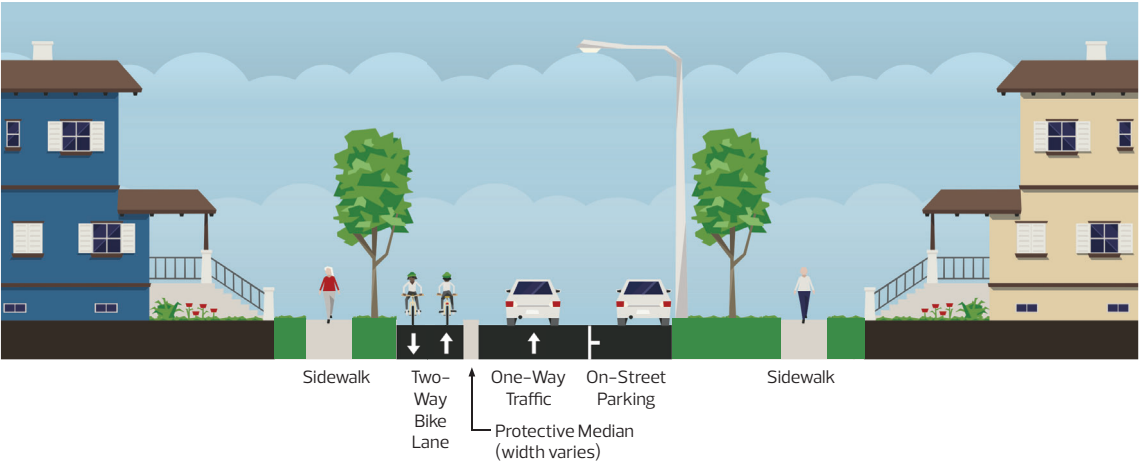
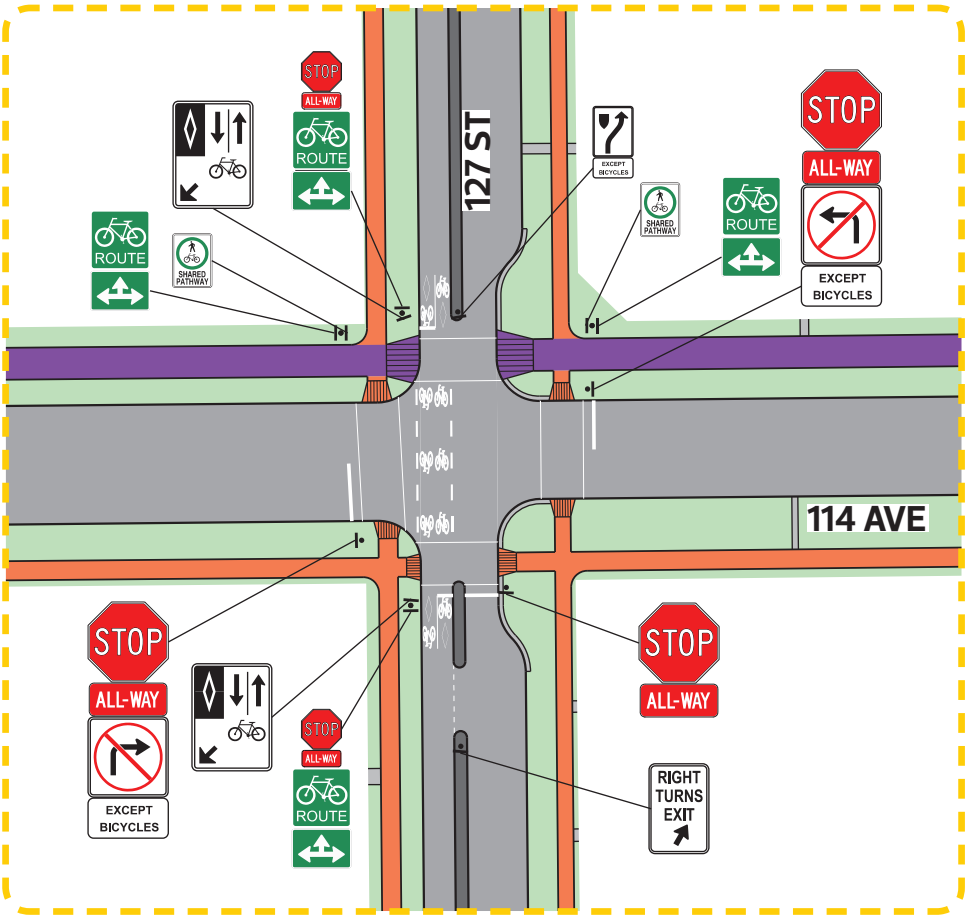

| | | | | | |
|---|---------------------------|---|----------------------|---|-------------|
|  | Sidewalk reconstruction |  | New raised crosswalk |  | Landscaping |
|  | New sidewalk construction |  | Bus stop pad | | |
| | New shared use path | | Road renewal | | |









INGLEWOOD

NEIGHBOURHOOD RENEWAL CONSTRUCTION

YEAR 2 – 2020

DETAIL LEGEND

- | | | | | | |
|---|---------------------------|---|----------------------|---|-------------|
|  | Sidewalk reconstruction |  | New raised crosswalk |  | Landscaping |
|  | New sidewalk construction |  | Bus stop pad | | |
|  | New shared use path |  | Road renewal | | |

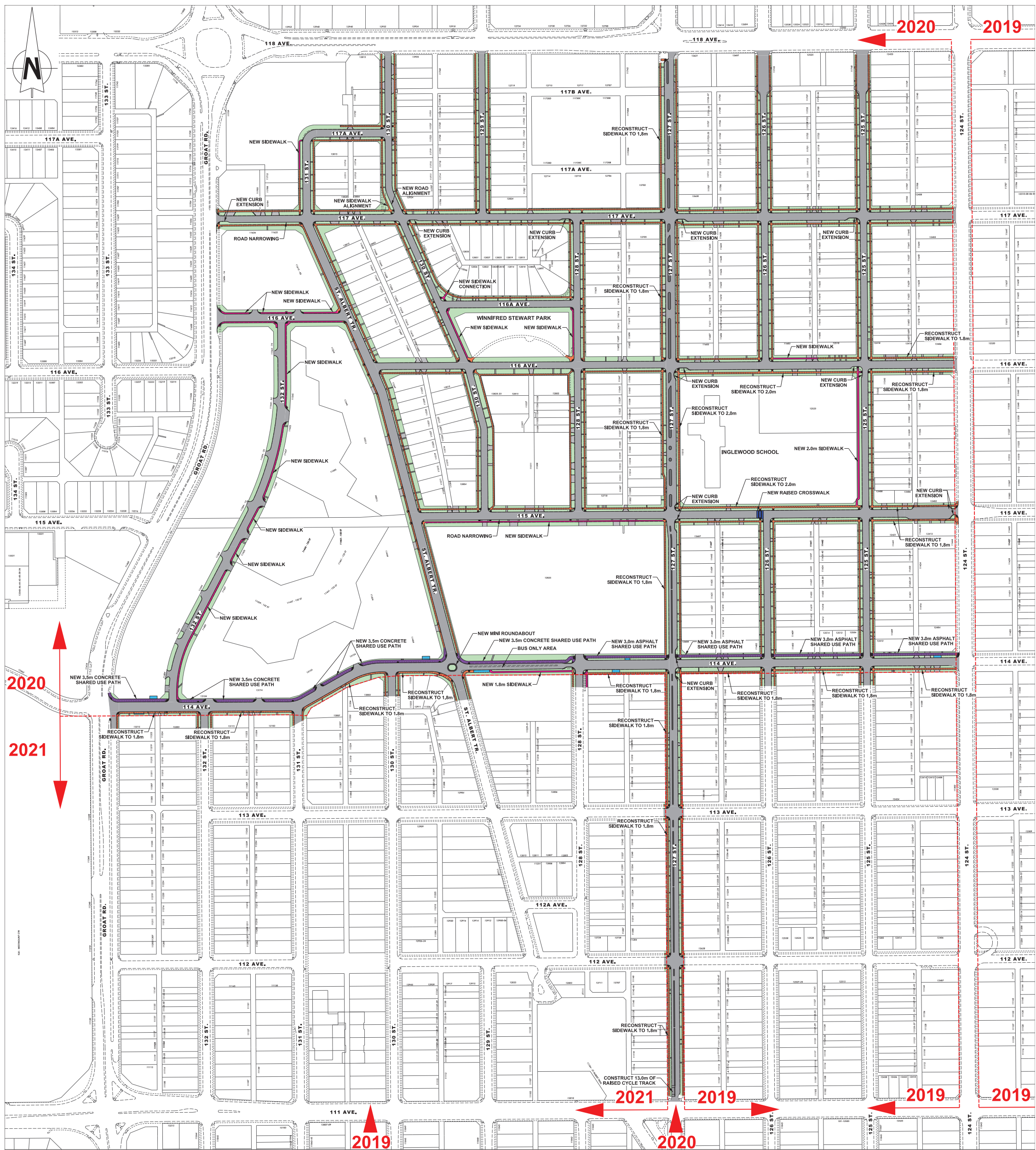

| | | | | | |
|---|---------------------------|---|----------------------|---|-------------|
|  | Sidewalk reconstruction |  | New raised crosswalk |  | Landscaping |
|  | New sidewalk construction |  | Bus stop pad | | |
|  | New shared use path |  | Road renewal | | |

