

What We Heard Pilot Sound District Park

ADVISE

City of Edmonton
Integrated Infrastructure Services
Open Spaces Planning and Design
December 2025
Edmonton.ca/PilotSoundDistrictPark

| **SHARE** YOUR VOICE
SHAPE OUR CITY

Edmonton

Table of Contents

Acknowledgements..... 3

Project overview.....4

 Project scope..... 5

Public engagement approach..... 6

 How we engaged.....7

 What we asked..... 7

 Who we heard from.....11

 What we heard..... 13

 What we did..... 17

 What happens next..... 18

Acknowledgements

The City of Edmonton acknowledges that the traditional land on which we reside is in Treaty Six Territory. We would like to thank the diverse Indigenous Peoples whose ancestors' footsteps have marked this territory for centuries, such as nêhiyaw/Cree, Dene, Anishinaabe/Saulteaux, Nakota Isga/Nakota Sioux, and Niitsitapi/Blackfoot peoples. We also acknowledge this as the Métis' homeland and the home of one of the largest communities of Inuit south of the 60th parallel. It is a welcoming place for all people who come from around the world to share Edmonton as a home. Together, we call upon all of our collective, honoured traditions and spirits to work in building a great city for today and future generations.

The project team thanks Edmonton Public Schools (EPSB), Edmonton Catholic School Division (ECSD), Alberta Infrastructure, open house and Soraya Hafez Pumpkin Walk attendees and survey respondents for sharing their thoughts and insights on the draft designs.

Project overview

The Pilot Sound District Park will serve neighbourhoods within the Horse Hill Area Structure Plan. This park is being planned alongside the development of a new Grade 7 to 9 Edmonton public school.

District parks are large sites designed to meet the recreational needs of multiple communities. The Pilot Sound District Park site currently includes Christ the King Catholic School, serving students from Kindergarten to Grade 9. The site is also designated for future facilities, including a future Edmonton public junior (Grades 7 to 9) high school. Alberta Infrastructure plans to begin the school construction in spring 2026. Additional plans for a City recreation centre and a park maintenance yard are in place. These components remain unfunded and their development timelines are currently unknown.

The image below shows the location of the park within the McConachie neighbourhood. The park is bordered by McConachie Drive to the south, an existing natural area to the north and residential uses to the east and west.



The image below shows space allocated for each amenity. This project focuses on the design of the open space only (shown in green), with other space on the site allocated for:

- The existing Catholic K-9 School in the southwest corner
- An area where the new Edmonton public junior high school will be built
- General locations for a future recreation centre and maintenance yard (yellow area)

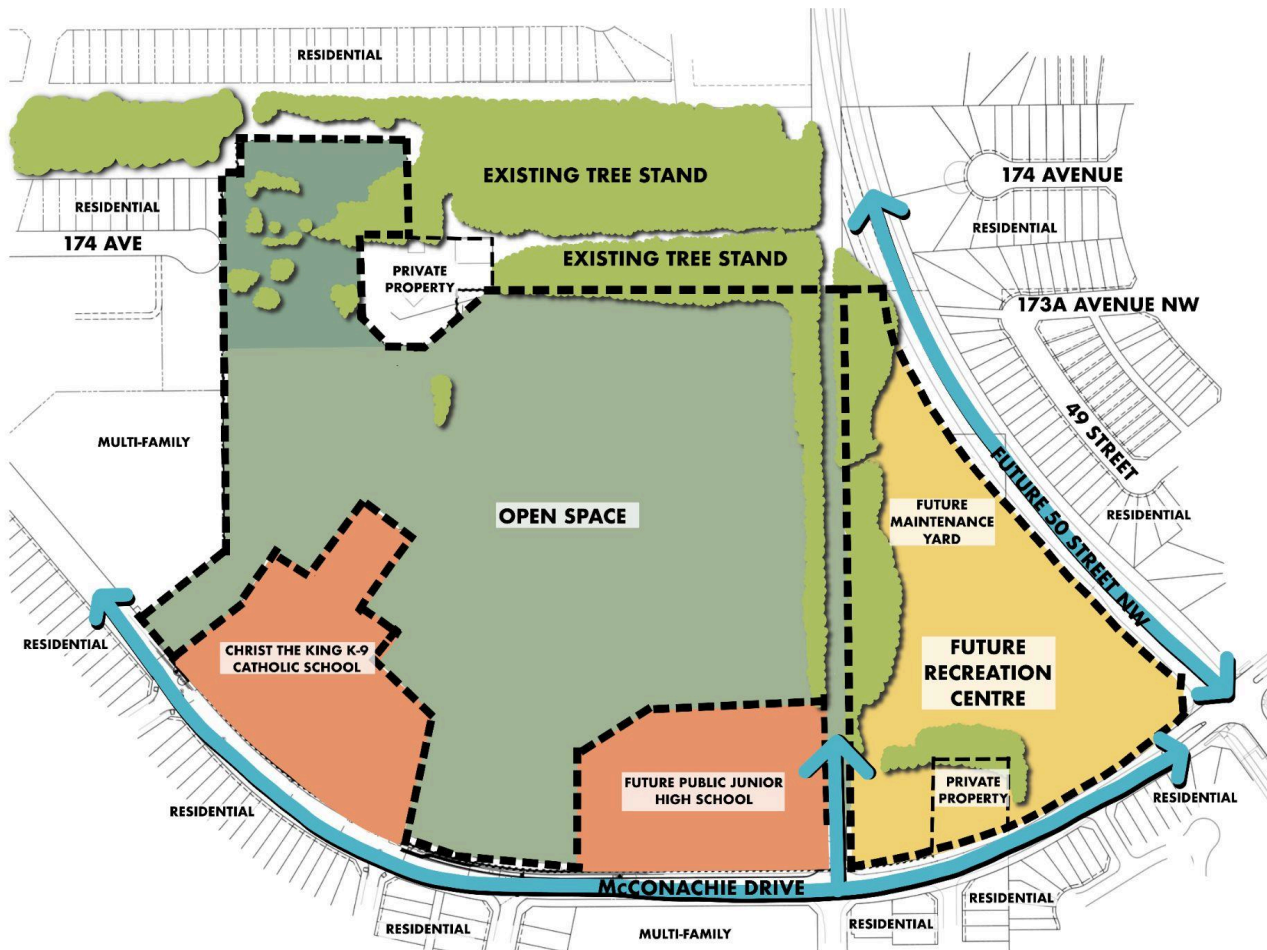

Project scope

The scope of work for the Pilot Sound District Park project includes base-level park amenities as defined in the [Urban Parks Management Plan](#). Base-level development includes:

- Site grading, levelling and seeding
- Sports fields complete with sports fixtures
- Landscaping, including tree planting
- Pathways, including connector paths to the neighbourhood
- Site furniture, including seating, picnic tables, waste bins and bicycle racks
- A park sign

The project is also guided by and supports implementation of the city-wide [Breathe: Green Network Strategy](#).

Public engagement approach

The City of Edmonton project team collaborated with both school boards (EPSB and ECSD) and Alberta Infrastructure to understand the schools' programming needs, ensuring the district park design aligns with these requirements. The team also engaged City sport and recreation staff to assess inventory and demand for sport fields and recreational amenities and consulted transportation and urban planning staff for additional expertise. A traffic assessment confirmed the planned park access road can accommodate anticipated future traffic volumes. The project team used the information gained from these knowledgeable parties to prepare a draft design.

As noted earlier, a district park is intended to meet broad recreational needs, so after meeting with school and City representatives, the project team wanted to gain feedback from the public. The public was asked to **ADVISE** the project team on the draft design. The City of Edmonton's Public Engagement Spectrum (below) notes an ADVISE level of engagement means the project team will consider public feedback as part of project decision making. Project decisions are also driven by the Urban Parks Management Plan, the city-wide Breathe Strategy, technical standards and budget to determine a final, preferred design.



How we engaged

Public engagement for the Pilot Sound District Park Project occurred from November 1 to November 21, 2025. A pop-up event was held at the Soraya Hafez Pumpkin Walk event, an in-person open house event at Christ the King School and an online survey were the primary engagement methods.

A [project web page](#) was established and the public was invited to view the draft design and share their views. The project page also hosted the online survey to gather feedback.

Information about the project and engagement opportunities were promoted through City of Edmonton social media accounts, yard signs within the area, posters at local businesses and a postcard distributed at local businesses and the pop-up event. The Horse Hill Community League also promoted the engagement opportunity to its membership.

There were 3,971 clicks on the Facebook and Instagram ads.

What we asked

Two draft design options were presented during engagement. The public was asked to provide feedback on:

- Which design option they preferred?
- How would they use the park?
- How would they get to the park?
- General thoughts on the draft design and project

Design Option 1 is on the next page and shows:

- Two open spaces
 - One between and north of the two school sites that includes a sliding hill and picnic area
 - One north of the future recreation centre
- Four pathways through the park:
 - A north-south pathway that starts between the existing school and the multi-unit development and follows the western boundary of the site
 - A second north-south pathway that starts at the intersection of 57 Street NW and McConachie Drive
 - A third north-south pathway that starts at the intersection of McConachie Drive and 55 Street NW and ends at the central east-west pathway
 - One east-west pathway that runs through the site, connecting all entrance pathways and ending at the future 50 Street NW extension
- Two 91m (275 foot) ball diamonds in the north central area of the park
- Two soccer fields, 100m x 64m, centrally located
- One existing soccer field, 100m x 64m, will be refurbished
- Space for a future maintenance yard west of the future 50 Street NW extension
- Space of a future recreation centre at the intersection of 50 Street NW and McConachie Drive
- Seating areas along the pathways
- Trees throughout

Option 1



Design Option 2 is on the next page and shows:

- Three open spaces:
 - One between and north of the two school sites that includes a picnic area
 - One between the future public school and future recreation centre
 - One south of the west baseball diamond that includes a sliding hill
- Three pathways through the park:
 - A north south pathway that starts at the southwest corner of the park, between the existing school and multi unit development and follows the western boundary
 - A north south pathway that starts at the intersection of McConachie Drive and 55 Street NW and ends at the future 50 Street NW extension
 - One east-west pathway runs through the site, connecting all entrance pathways
- One pathway that connects the two schools with each other and the main pathways
- Two 91m (275 foot) ball diamonds in the north central area of the park
- One soccer field, 100m x 64m, north of the future public school
- One combination football and adult soccer field, north of the future public school
- One soccer field, 76m x 55m, north of the catholic school
- One soccer field, 49m x 27m, north of the catholic school
- Space for a future maintenance yard east of the future 50 Street NW extension
- Space of a future recreation centre at the intersection of 50 Street NW and McConachie Drive
- Seating areas along the pathways
- Trees throughout

Option 2



Who we heard from

Pop-up event

On November 1, 2025, representatives from the project team were available at the community's Pumpkin Walk event held at Soraya Hafez. The main focus of the pop-up event was to inform the public about the project and opportunities to provide feedback. Postcards were available for distribution with open house information, the project web site and when to expect the online survey.

Open house

On November 13, 2025, the project team hosted an open house at Christ the King Catholic School. A total of 18 members of the public and three teachers attended the event, discussed the project with the project team and provided feedback on the design options. Most attendees noted their preferences for option two

Discussions from the event include:

- Concerns regarding parking and traffic safety
- Conditions of the existing field
- Project timing
- Considering field flexibility - larger fields can have multipurpose

Event attendees suggested the following uses or amenities:

- Dog park
- Beach volleyball
- Pickleball
- Large football field
- Outdoor running track
- Cross-country skiing trail



We need to hear from you!

Public event (drop-in)
Nov. 4 p.m. - 7 p.m.
Christ the King Catholic School 180
McConachie Dr NW

Online Survey
Available from
Nov. 6 to Nov. 21

Unable to attend? Scan the QR Code for ways to share your feedback

Learn more by visiting:
edmonton.ca/PilotSoundDistrictPark

SHARE YOUR VOICE
SHAPE OUR CITY

Edmonton



Your thoughts on the design

Which design do you prefer?

Concept Option 1

Concept Option 2

Reason you prefer it?

Concept Option 1

Concept Option 2

6 | **SHARE YOUR VOICE**
SHAPE OUR CITY

Edmonton



Online survey

A total of 476 respondents completed the survey. The majority (86 per cent) of respondents indicated they lived in McConachie and nearby communities (Brintnell, Cy Becker, Hollick-Kenyon, Matt Berry and Schonsee). Many other respondents (six per cent) selected “other” when answering the question about where they live. Most respondents who selected “other” were from neighbourhoods in northeast Edmonton (Bannerman, Clareview, Fraser, Hairsine, Horse Hill, Kernohan, Kirkness, Lago Lindo, Mcleod, Miller, Ozerna and Quarry Ridge), or noted they intended on moving to the neighbourhood. Few respondents (2 per cent) chose not to answer this question.

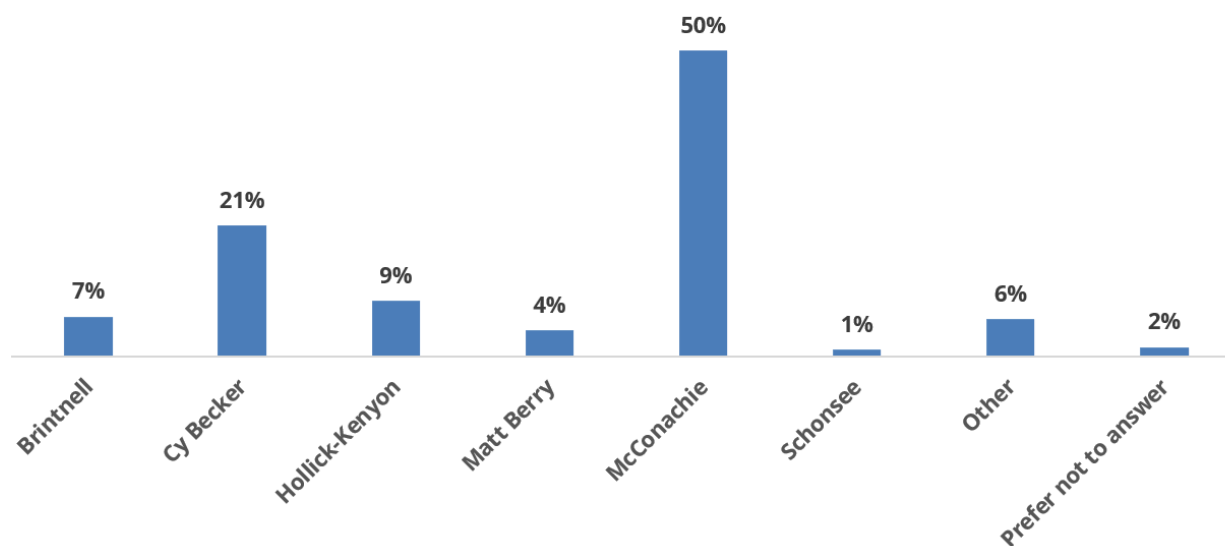

The majority (62 per cent) of respondents had children/grandchildren under the age of 18 years in their household.

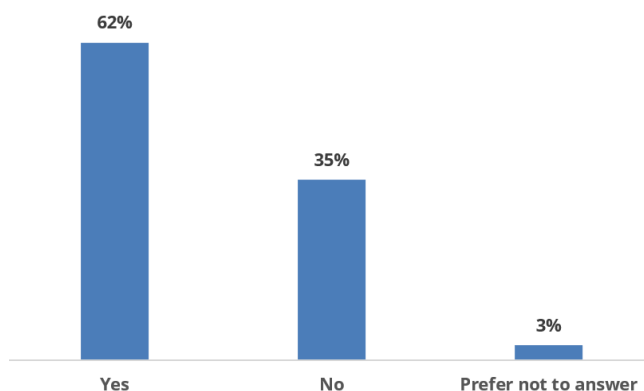

Most survey respondents were between the ages of 25 to 54 years old (78 per cent). More than half identified as female (58.3 per cent), while a smaller percentage identified as male (35 per cent). A small portion (less than two per cent) of respondents identified as non-binary, transgender, Two-Spirit or another gender. A few respondents (five per cent) chose not to answer this question.

What we heard

Expected park uses

Respondents were asked to select how they or a member of their household expect to use the park and its amenities. Respondents could select as many uses as applied. As noted in the chart below, the most desired uses include using park pathways for walking and rolling, passive activities such as relaxing, reading, spectating and sports field use.

Expected Park Use	Percentage of Respondents	Number of Respondents
Use sports fields	49%	232
Attending a school at the park	32%	152
Walking, jogging or running	72%	344
Informal activities such as relaxing or reading	46%	221
Using pathways to travel through	46%	221
A place to meet and socialize	52%	247
Other (Please specify):	11%	52
Dog walking	7%	34
Recreation centre / indoor facilities	5%	23
Sledding / toboggan hill / sliding	2%	10
Tennis, pickleball, general courts	2%	9
Spectating sports	1%	5
Playground	<1%	2
Biking	<1%	3
I do not plan to use the park	3%	15
Not sure	4%	19
Multiple selections will not total 100% or equal total respondents		

A few (10 per cent) respondents selected “other” and specified an activity they would like to do or see at the park. The “other” desired activities/amenities are listed below from most to least frequently mentioned.

1. Hard surface sports
 - Pickleball, tennis and basketball are highly desired
2. Dog walking and/or a dog park
3. Playground for children
4. City Facilities (recreation facility amenities and programming and library)

Design option preferences

Respondents were asked to review and indicate their preferred park design option. As noted in the chart below, a majority (61 per cent) of respondents preferred Option 2. Less than one third (29 per cent), favoured Option 1. Few (eight per cent) respondents noted they had no preference

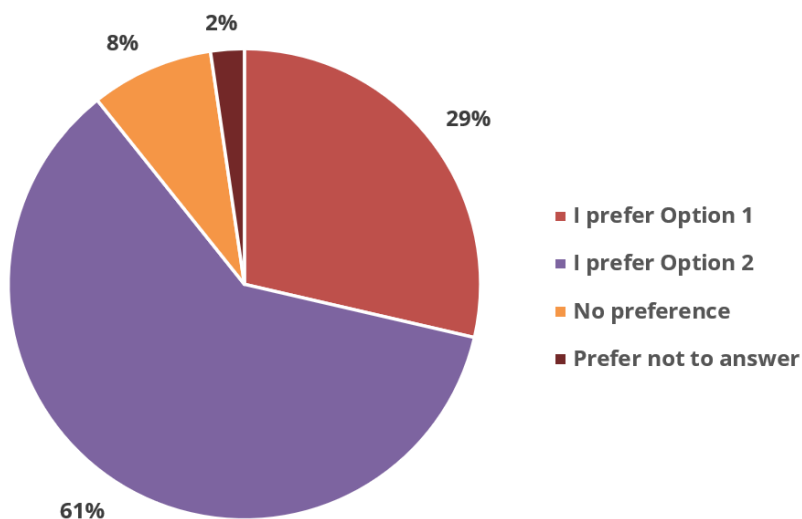

Respondents' reasons for a design preference are shown in the chart below. Overall, respondents preferred how elements were presented in Option 2. Largely, respondents preferred the types and size of sports fields and the area of naturalized restoration proposed in Option 2. There was a percentage of respondents who preferred a design option based on the location of pathways, location of open spaces and location of the sliding hill.

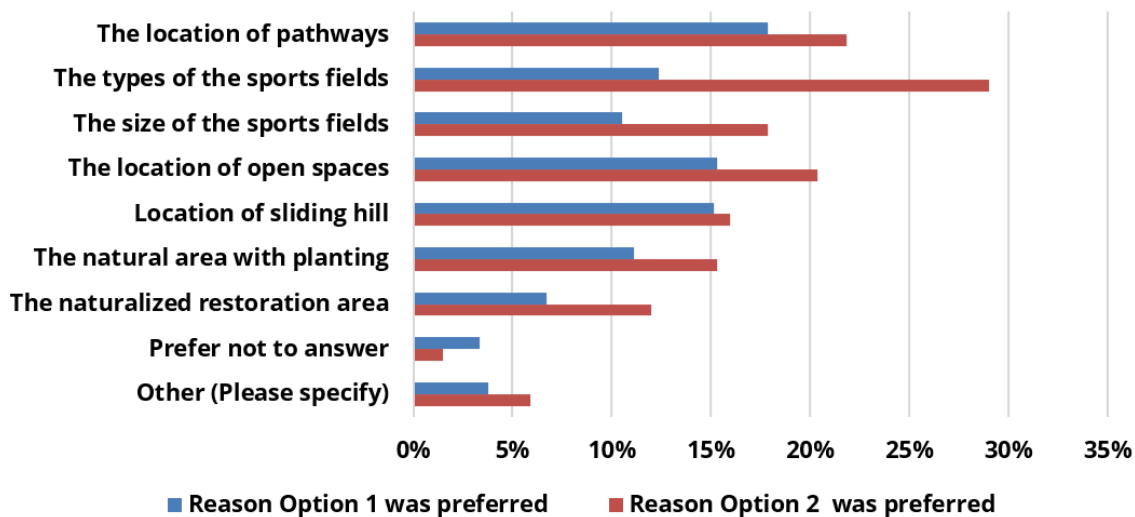

Travel methods to the park

As shown in the charts below, respondents expect to use a variety of travel methods to get to the park, with vehicle use and walking or running the most likely. Almost one third (30 per cent) of respondents expect to “roll” to the park. Rollers are most likely to cycle (97.8 per cent) and use a scooter (39.1 per cent). Eight per cent of rollers expect to use a mobility aid or wheelchair.

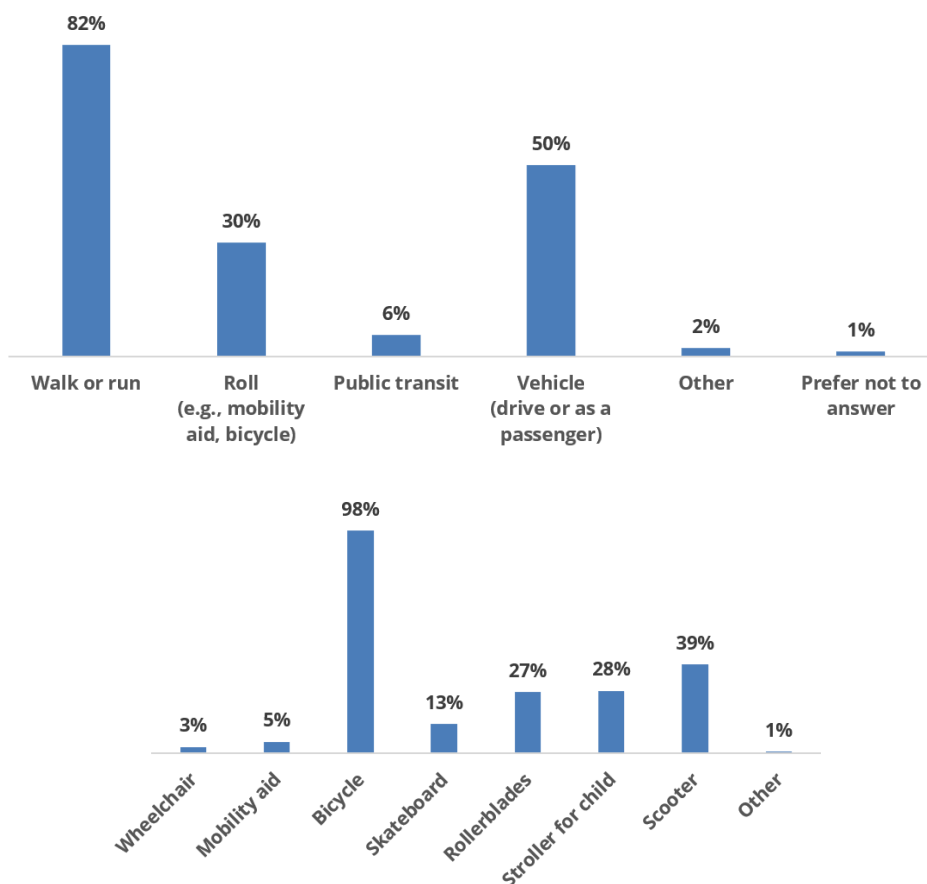

Overall comments

Engagement participants were asked to include any additional comments for the project team. The written comments were summarized below.

Safety and security

Safety and security were seen as essential. Respondents sought well-lit, clearly marked pathways and crossings, traffic-calming measures near schools and park facilities and thoughtful design that minimized risks for children and park users. Additionally, there were concerns about crime that might have taken place in areas of the park that were hidden, suggesting a need for security lighting, emergency call stations and wayfinding.

Parking and traffic

The project team heard a number of parking and traffic concerns during the engagement period. Participants expressed frustration with existing congestion and limited parking, particularly during school drop-off and pick-up times. Many foresaw additional facilities, such as a recreation centre and more sports fields, would further strain the street network and intensify safety risks for pedestrians, cyclists and drivers. There was a clear demand for comprehensive traffic impact assessments and a well-defined parking strategy that addressed both daily and event-based needs. Engagement participants advocated for dedicated parking lots for each major facility, improved traffic flow through features like new or expanded roads and safer intersections and transparent communication about how these issues would be managed.

Dog parks and pet amenities

Many engagement participants believed dog ownership has increased and noted they currently used informal open spaces for this purpose. These engagement participants felt underserved by the lack of formal options nearby. Feedback suggested a dog park should have been centrally located but not next to schools or playgrounds. Amenities such as seating, shade, water fountains and dog waste bins were also considered important for usability and maintenance.

Diversity of sports facilities

Engagement participants expressed a desire for a broader diversity of sports amenities. While soccer and baseball fields were valued, many felt that the current plans overemphasized these at the expense of other popular activities. Requests included tennis and pickleball courts, basketball courts, cricket pitches, field hockey grounds, skate and bike parks, and additional ice rinks for hockey and skating. Community members believed that these additions would have served a wider range of ages and interests and helped ensure the park's year-round usefulness. Flexibility was also considered important, with multipurpose courts and open lawns suggested as ways to accommodate changing recreational trends.

Green space and naturalization

Green space and naturalization were highly valued in the community. Numerous comments highlighted the importance of preserving open lawns, planting native trees and shrubs, providing shade and maintaining areas for unstructured play, walking and relaxation. There was a desire for picnic areas, ponds and naturalized landscapes that supported both recreation and environmental health. Residents wanted the park to strike a balance between programmed facilities and flexible, open space, ensuring that it remained a place for all to enjoy.

Playgrounds, youth and family amenities

Playgrounds, spray parks, outdoor fitness equipment and other family and youth--oriented amenities were requested by many, with an emphasis on inclusivity for children with disabilities and spaces that could be enjoyed by all ages. There was also strong support for multi-season use, with requests for sledding hills, outdoor skating rinks and convertible courts that could accommodate both winter and summer activities.

Overcrowding and overdevelopment

Engagement participants commented on concerns about overcrowding and overdevelopment within the park site. With all the programmed facilities, respondents were worried the area may feel cramped and reduce the flexibility of the park. Some wanted to ensure not all open space was dedicated to formal sports and that there was sufficient room for informal gatherings, picnics and casual play.

Future recreation centre

While the recreation centre is outside the scope of this project, input related to the centre will be shared with the City's Community and Recreation Facilities team. Some respondents commented on amenities and programming for the future recreation facility. Respondents noted the facility should consider amenities such as a swimming pool, additional ice rinks, sauna and child care. Others worried about its proximity to schools and the impact on traffic and safety. The need for public washrooms, covered seating and universally accessible design was emphasized. Many believed the centre should be easily reached by all, with convenient parking and access to transit or active transportation connections. Feedback gathered during this engagement will be reviewed when funding for the recreation centre is secured.

What we did

All public engagement feedback was shared with the project design team for consideration as the design moves forward. Some public feedback was outside the scope of this project, but is valuable to other City departments. The results of this engagement will be shared with Urban Planning and Economy, [Breathe: Green Network Implementation Project](#) team to inform their work.

Working across different levels of government, site partners and City departments is complex and collaborative. The park will provide amenities to support the future recreation facility and future school programming with amenities such as sports fields and pathway connections. At the same time, it is anticipated the future recreation facility and school developments will provide amenities that benefit the park such as parking and indoor recreation opportunities. Open space has been included in the design for unstructured recreation opportunities like frisbee or yoga. There is also open space that could accommodate amenities above base level in the future, as funding allows.

The chart below outlines base-level amenities included in the design. It also outlines other amenities highly valued by public engagement respondents. As funding does not allow for above base-level amenities at this time, these additional amenities have not been included.

District Park Amenities	BASE LEVEL* to be delivered through this project	ABOVE BASE LEVEL Potential future development depending on funding and need
Site grading, leveling and planting grass seed or sod	x	
Tree planting and landscaping	x	
Sports fields and fixtures	x	
Park sign	x	
Furniture: benches, picnic tables, bike racks, trash cans	x	
Shared-use pathways	x	
Parking	Expected to be provided with other facilities on site	Interim facility based on Transportation Impact Assessment and Parking Management Plan
Pickleball/tennis		x
Spray park		x
Ice rink		x
Playground		x
Basketball court		x
Off leash dog park		x
Gazebo or picnic shelter		x
Running track		x

*Base level development as defined in the City of Edmonton's [Urban Parks Management Plan](#)

Alberta Infrastructure is responsible for development within the school parcel, including parking, pathways, lighting, landscaping and furniture.

What happens next

The project team will continue to work with site partners to further the park design. A Transportation Impact Assessment and Parking Management Plan will further ensure adequate parking is provided on and around the site once fully developed. A Biophysical Assessment will also be completed to assess the existing natural areas' environmental importance and how it could be affected by development. A preferred design will be developed and shared on the project website at edmonton.ca/PilotSoundDistrictPark. Funding to deliver the project will be requested in fall 2026 as part of the 2027-2030 Capital budget.

The design of the new Grade 7-9 public school is currently underway. Edmontonians are encouraged to contact

EPSB directly for information related to the school design and development.

The project team thanks Edmontonians who shared their views about the draft design and looks forward to sharing the preferred design in the coming months.