

What We Heard

Hays Ridge Community Park

ADVISE

City of Edmonton
Integrated Infrastructure Services, Open
Spaces Planning and Design
June 2025
Edmonton.ca/CommunityParkDevelopment

SHARE YOUR VOICE
SHAPE OUR CITY

Edmonton

Table of Contents

Acknowledgements.....	3
Project overview.....	3
Community park project scope.....	3
Public engagement approach.....	4
Gender-based analysis plus (GBA+) considerations.....	4
How we engaged.....	5
What we asked.....	5
Who we heard from.....	6
What we heard.....	6
What we did.....	9
What happens next.....	10

Acknowledgements

The City of Edmonton acknowledges that the traditional land on which we reside is in Treaty Six Territory. We would like to thank the diverse Indigenous Peoples whose ancestors' footsteps have marked this territory for centuries, such as nêhiyaw/Cree, Dene, Anishinaabe/Saulteaux, Nakota Isga/Nakota Sioux, and Niitsitapi/Blackfoot peoples. We also acknowledge this as the Métis' homeland and the home of one of the largest communities of Inuit south of the 60th parallel. It is a welcoming place for all people who come from around the world to share Edmonton as a home. Together, we call upon all of our collective, honoured traditions and spirits to work in building a great city for today and future generations.

The project team thanks the Edmonton Catholic School Division (ECSD), Alberta Infrastructure, and residents for sharing their thoughts and insights on the draft design.

Project overview

The City of Edmonton is planning the Hays Ridge Community Park to support the implementation of the provincial [School Construction Accelerator Program](#). This park is being planned alongside the development of a new ECSD Kindergarten to Grade 9 school. The park and school site is located at 31 Avenue and Hays Ridge Drive SW.

The new community park is designed to support programming at the school and for the enjoyment of surrounding community members. The City worked closely with ECSD to develop the draft design for the park. Planning and design of the school is not within the community park project scope.

Community park project scope

The scope of work for the Hays Ridge Community Park project includes base-level park amenities as defined in the [Urban Parks Management Plan](#). Base-level development includes:

- Site grading, levelling and seeding
- Sports fields complete with sports fixtures
- Landscaping, including tree planting to plant 55 trees per Hectare
- Pathways, including connector paths to the neighbourhood
- Site furniture, including seating, picnic tables, waste bins and bicycle racks
- A park sign
- A playground

The project is also guided by the [Community Parks Framework](#) and supports implementation of the city-wide [Breathe: Green Network Strategy](#).

Public engagement approach

The City of Edmonton project team met with ECSD and Alberta Infrastructure representatives to gain a thorough understanding of the school's programming needs and the ECSD draft design for the school. This collaborative approach ensures the City's park design integrates the school's needs. The project team also met with City sport and recreation staff to gain insight on the City's overall inventory and demand for sport field types and recreational opportunities. The project team used this information to develop a draft design for the community park.

As noted earlier, a community park is intended to meet both school and community needs, so after meeting with school and City representatives, the project team wanted to gain feedback from the public. The public was asked to **ADVISE** the project team on the draft design for Hays Ridge Community Park. The City of Edmonton's Public Engagement Spectrum (below) notes that an ADVISE level of engagement means the project team will consider public feedback as part of project decision-making. Project decisions are also driven by the Urban Parks Management Plan, Community Parks Framework, technical standards, and budget to determine a final, preferred design.



Gender-based analysis plus (GBA+) considerations

Canadian Census (2021) data indicates, residents in the Hays Ridge neighbourhood are well-educated and almost all residents know English. Hays Ridge residents have very low rates of low-income. For these reasons an online method of engagement was used as residents were unlikely to experience language barriers and digital devices and internet were likely to be affordable.

How we engaged

Public engagement for the Hays Ridge project occurred from April 30 to May 20, 2025. An online survey was the primary engagement method.

The project was listed on the City of Edmonton [Community Park Development webpage](#), and the public was invited to view the draft design and contact the project team to share their views. The project page also hosted the online survey to gather feedback.

Information about the project and the opportunity to complete the survey was promoted through City of Edmonton social media accounts, road signs within the area, and a postcard mailout to neighbourhoods surrounding the project site.

What we asked

The public was asked to provide feedback on:

- Satisfaction with the draft design,
- Preferred playground elements, and
- Local insights relevant to the draft design and project.

The draft design presented during the engagement is shown below.

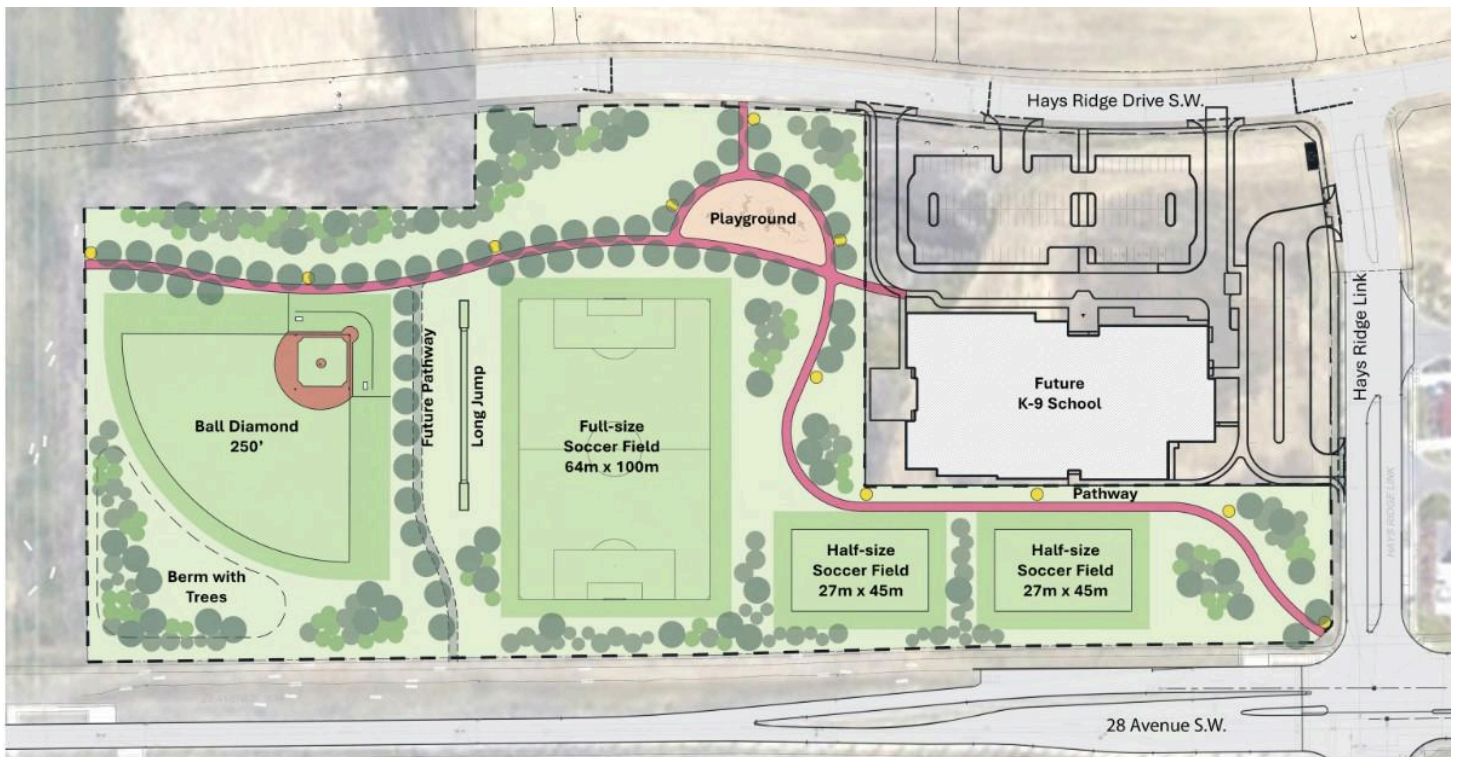

Who we heard from

A total of 341 residents completed the survey, with the majority (87 per cent) of respondents indicating they lived in Chappelle, Hays Ridge, and Paisley neighbourhoods. Many other respondents (12 per cent) lived in Graydon Hill, Heritage Valley Area, Glenridding Ravine, and other neighbourhoods near the project site. A few respondents (one per cent) chose not to answer this question.

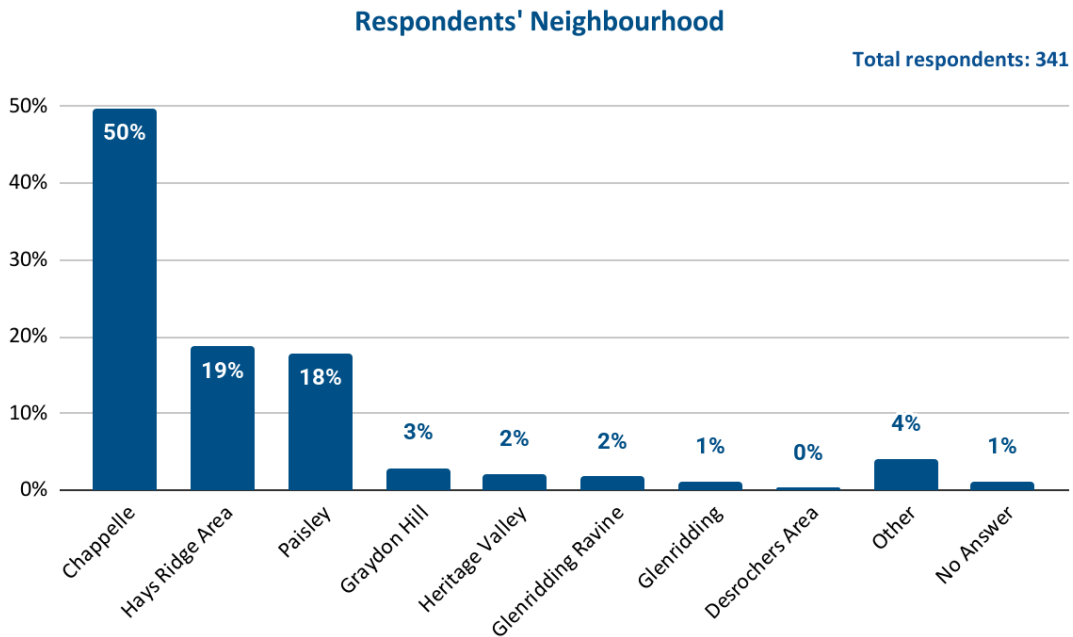

The majority of respondents had children/grandchildren under the age of 18 years in their household. About one-third (34 per cent) of respondents expected to send their children to the new school when it opens. A similar number were unsure (31 per cent) or indicated they would not send their children to the school (32 per cent).

Percentage of Respondents with Children under 18 years of age

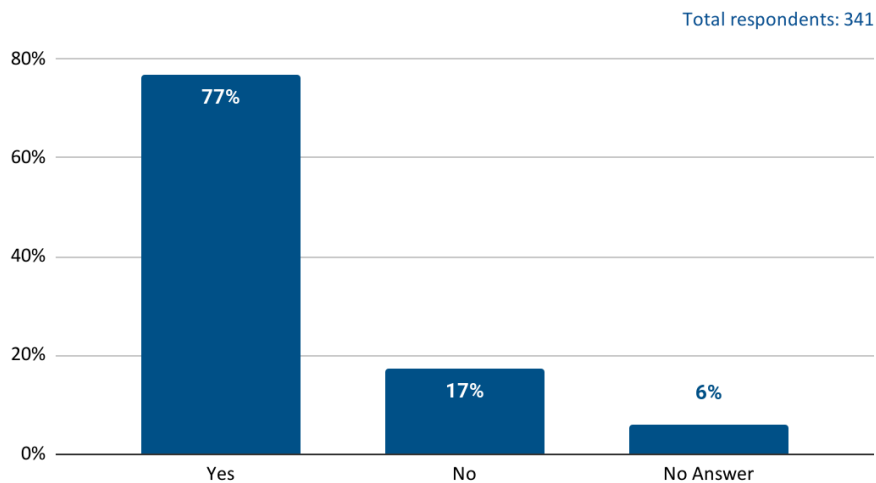

What we heard

Most respondents (72 per cent) were somewhat satisfied or very satisfied with the draft design as shown in the chart below.

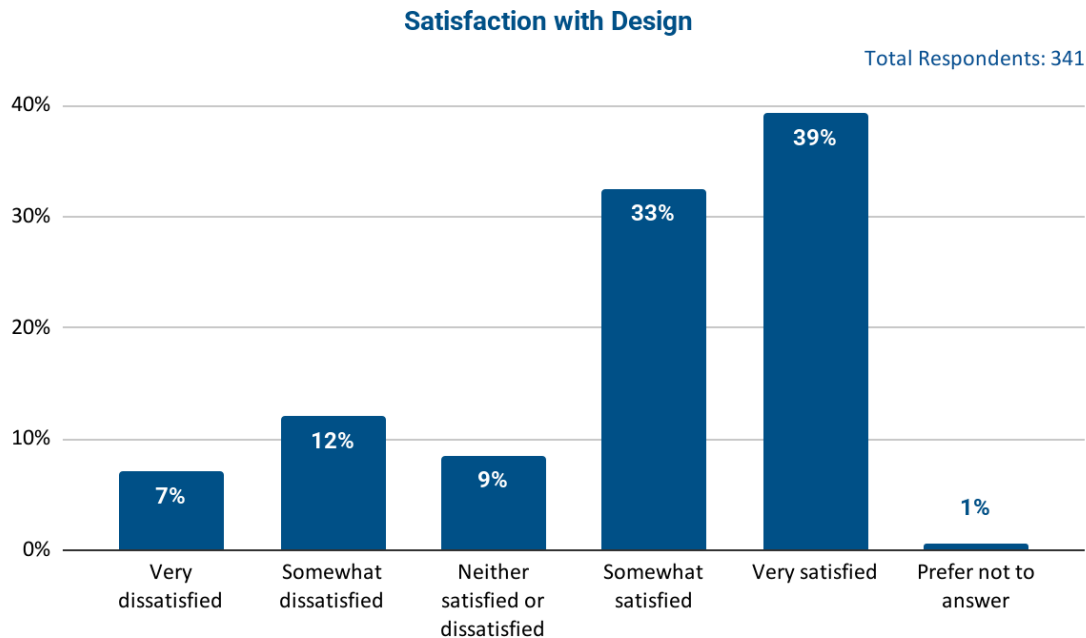

The written comments survey respondents offered related to the design are summarized below.

- Amenities** respondents would like included in the design. Basketball, volleyball, tennis, and pickleball were frequently mentioned. Less frequently mentioned were an ice rink, bike pump track, outdoor exercise equipment, swimming pool, and a track around one of the soccer fields. Many people commented that they would rather have one or some of these amenities instead of one of the small soccer fields.
- The desired elements** respondents wanted included in the park. These included: green space, trees, flowers, and shade. Shade near the playground was deemed especially important. Respondents also asked that the project team consider more pathways and pathway connections, particularly to and from the playground, ravine, 28 avenue, and around the entire park. Several people also supported waste bins, benches, and picnic tables. These elements are included in base-level development.
- Safety concerns** related to baseballs or soccer balls going into busy streets during play. One respondent worried about the proximity of the baseball field to powerlines and the possibility of a ball striking a powerline.
- Local traffic and parking** were a concern amongst some respondents, especially those who indicated dissatisfaction with the draft design. These respondents expressed frustration with the current traffic congestion that makes getting into and out of their neighbourhoods difficult. They were concerned that the park and school would worsen traffic congestion. Many people also worry about sufficient parking spots when the sports fields are in use.

- A few respondents wrote that they believed the need for a park and playground in their neighbourhood was being overlooked and questioned why a project in Hays Ridge was being prioritized over other Edmonton neighbourhoods.
 - It is significant to note that the catalyst for the Hays Ridge Community Park is related to the Alberta Government's [School Construction Accelerator Program](#).

Survey respondents were also asked how they would likely travel to the park when it is completed. Most (82 per cent) indicated they would walk/run, and about one third indicated that they would “roll” (e.g., bicycle, wheelchair) or use public transit.

Likely Method of Travel to Park

Multiple Selections will not total 100%

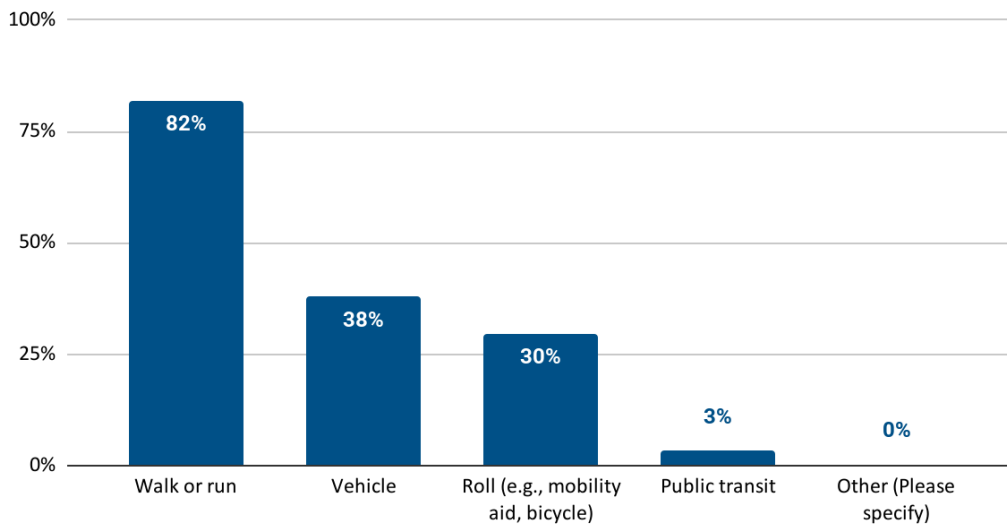

Method of Rolling to Park

Total "Roller" Respondents: 95

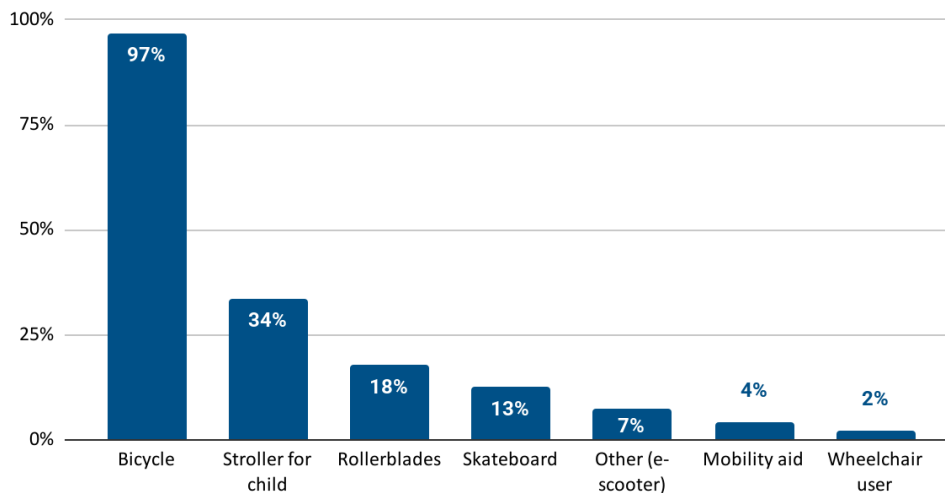

The engagement survey also asked about activities and experiences people would like to see at the new playground. Survey respondents favoured play elements that involved swinging, sliding, and climbing.

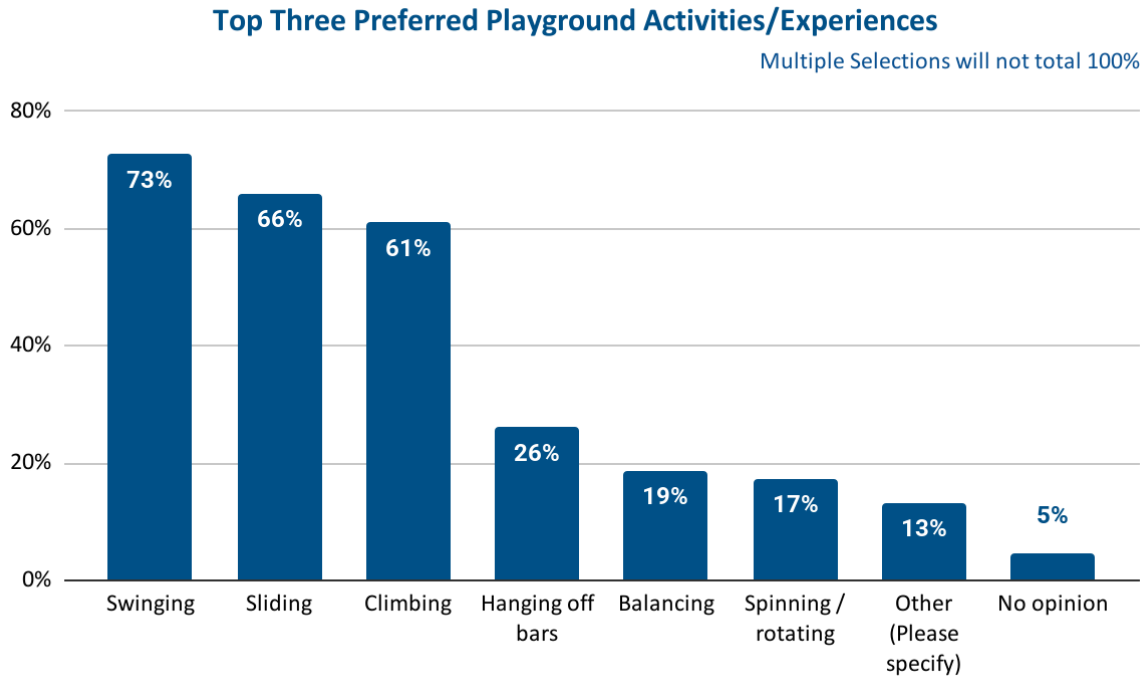

Most respondents who selected “other” play elements suggested a spray park or water park. A few respondents asked for a zipline, exercise equipment for adults, and activities that many age groups could play together, such as basketball and disc golf. Similarly, others mentioned they would like the playground to offer play experiences for all ages and abilities. Two respondents would like sand for play, while another respondent asked that no sand be included at the playground. Other comments related to non-play elements, such as seating and a water fountain.

What we did

All public engagement feedback was shared with the project design team. Where technical, policy, and cost constraints allow, the project team will incorporate public feedback into the final preferred design.

Working across different levels of government and site partners is complex and collaborative. The chart below outlines park amenities that are included as part of the City’s base level community park development, are part of ECSD school design development, or may be included at the discretion of the provincial government. The Hays Ridge Community Park must offer amenities to meet ECSD Kindergarten to Grade 9 schools’ programming needs and, at the same time, strive to offer residents an open space focused on ecology, celebration, and wellness.

Community Park Amenities	City of Edmonton (CoE) Base level Development	Alberta Infrastructure (AI) School Site Development
Ground grading, leveling and seeding	CoE	AI
Tree planting	CoE	AI
Sports fields and fixtures – baseball and soccer	CoE	
Park sign	CoE	
Playground	CoE	
Benches, picnic tables, trash cans	CoE	
Shared-use pathways with lighting	CoE	
Bicycle parking/racks		AI
Parking lot		AI
Basketball / Hard surface court		AI*
Social gathering places (e.g., gazebo, plaza)	N/A	N/A
Ice rink	N/A	N/A

CoE – provided through the City of Edmonton's base-level development

AI - provided through the provincial government, Alberta Infrastructure

AI* - provided at the discretion of the provincial government, Alberta Infrastructure

N/A - not applicable/possible - there is no space to develop a community league at the Hays Ridge site. Note: Community parks in Edmonton that also have a community league on the site may develop amenities such as ice rinks or social gathering spaces through community league initiatives and fundraising. The Hays Ridge community park site does not have a community league, so these amenities are not applicable to the project at this time.

What happens next

The project team will reach out to the public again in 2026 for feedback on playground design options. The project team will continue to work with site partners to further the community park design. A preferred design will be developed in 2026 and shared on the project website at edmonton.ca/CommunityParkDevelopment.

The new school is anticipated to open in 2028. Edmontonians are encouraged to contact ECSD directly for information related to the school design development.

The project team thanks Edmontonians who shared their views about the draft community park design and looks forward to continued collaboration with residents, ECSD, and Alberta Infrastructure as the project proceeds.