

Woodcroft Neighbourhood Renewal

As part of the 2013 Neighbourhood Renewal Construction Programs, the City of Edmonton, Transportation Services will be involved in the reconstruction of the Woodcroft Neighbourhood. Please refer to the map on the back of this bulletin for the scope of work for 2013 construction seasons. The contractor will be delivering another bulletin prior to removals on your street with estimated start and end dates of construction on your side of the street.

Construction is tentatively scheduled to commence in the week of April 29, 2013.

Scope of work

The construction consists of removal and replacement of public sidewalk, curb and gutter, streetlight replacement as required and reconstruction and paving of the road.

Access

During the construction period, one lane of traffic in each direction will be maintained at all times, under flagperson control. No parking will be permitted in signed areas. Access to businesses, residences and alleys will be maintained, where possible, at all times. Emergency access will be maintained at all times. All residents are asked to access their homes through the alleys for the majority of use during construction.

If you have special access requirements, such as DATS, please advise one of the contact persons listed below.

Toward the completion of each portion of the project, the roadway will be closed to traffic on selected days to facilitate road reconstruction and asphalt paving. A bulletin will be circulated to the affected homes and businesses 5 working days prior to this work.

Landscaping

As part of the construction process, some re-landscaping will be necessary.

Please mark all underground sprinkler systems to avoid damage during construction.

Please retain this bulletin for contact information.

For further information, please contact:

Mr. Adnan Akram Eng.
Transportation Services
Phone: 423-6728

**(Primary contact for
all construction
information)**

Mr. Tony Sestito, R.E.T.
Transportation Services
Phone: 944-5667

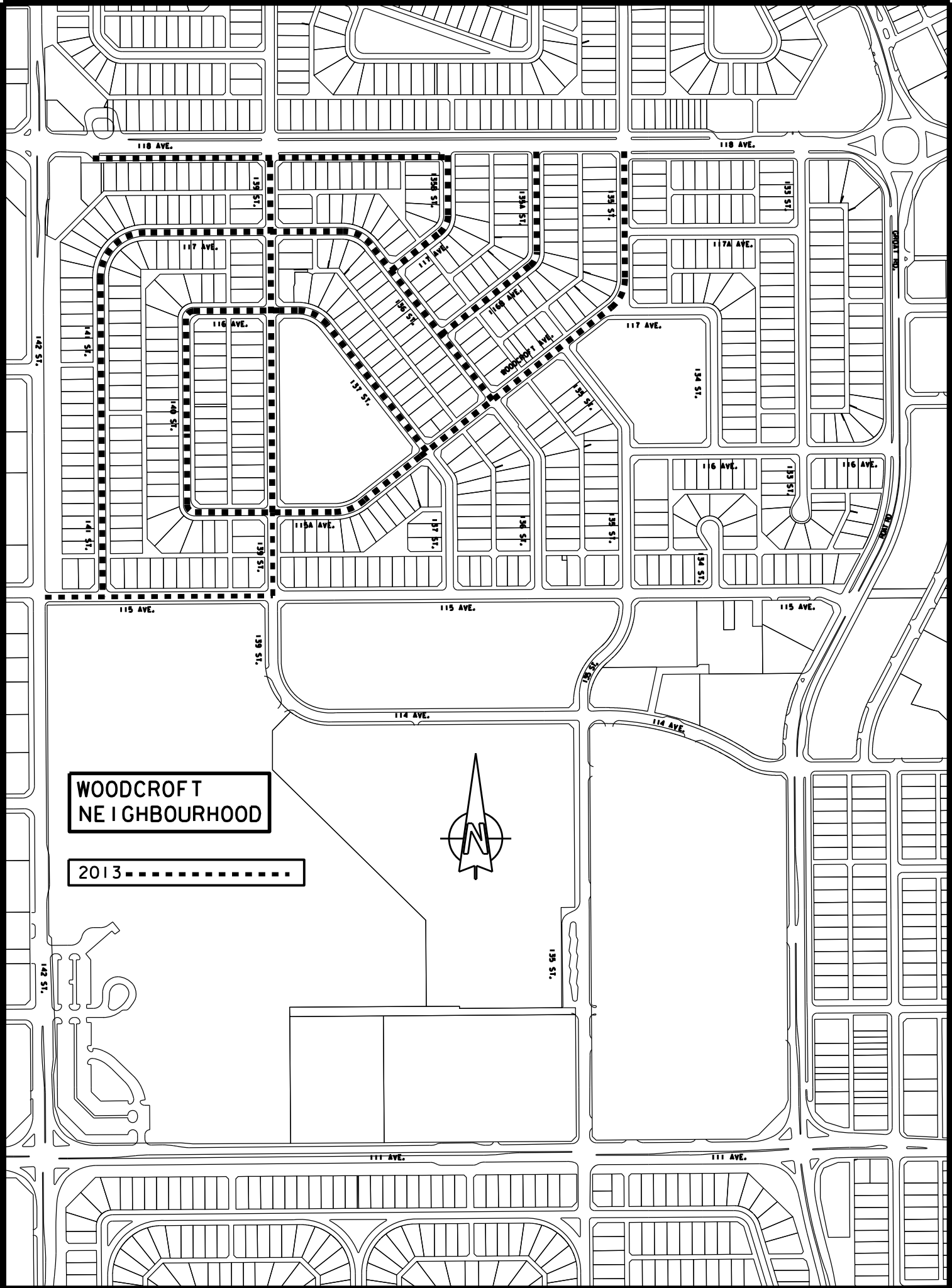

**WOODCROFT
NE | GHOUBHOOD**

2013 - - - - -

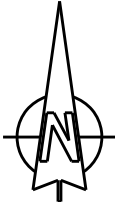

118 AVE.

118 AVE.

139 ST.

139A ST.

139A ST.

139 ST.

139 ST.

117 AVE.

117A AVE.

116 AVE.

117 AVE.

116 AVE.

116 AVE.

115 AVE.

115 AVE.

115 AVE.

139 ST.

114 AVE.

114 AVE.

**WOODCROFT
NE | GHOUBHOOD**

2013 - - - - -

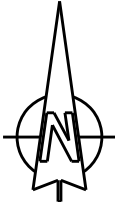

142 ST.

142 ST.

111 AVE.

111 AVE.