

## Parkdale SW Neighbourhood Renewal

As part of the 2009 construction program, the City of Edmonton, Capital Construction Department will be involved in construction in the Parkdale Neighbourhood. Please refer to the map on the back of this bulletin for the scope of work for the 2009 construction season.

**Construction is scheduled to commence on May 5, 2009. (Weather permitting)**

### Scope of work

The construction consists of removal and replacement of public sidewalk, curb and gutter, streetlight as required, and reconstruction and paving of the road.

### Access

During the construction period, one lane of traffic in each direction will be maintained at all times, under flagperson control. No parking will be permitted in signed areas. Access to businesses, residences and alleys will be maintained at all times. Emergency access will be maintained at all times. All residents are asked to access their homes through the alleys for all other use.

If you have special access requirements, such as DATS, please advise one of the contact persons listed below.

Toward the completion of each portion of the project, the roadway will be closed to traffic on selected days to facilitate road reconstruction and asphalt paving. A bulletin will be circulated to the affected homes and businesses one week prior to this work.

### Landscaping

As part of the construction process, some re-landscaping will be necessary. A separate landscaping bulletin will be circulated to affected homes and businesses.

**Please mark all underground sprinkler systems to avoid damage during construction.**

### Please retain this bulletin for Contact Information.

For further information, please contact:

**Mr. Mark Morton**  
Roadways Construction  
Phone: 944-7692

**Mr. Tony Sestito**  
Roadways Construction  
Phone: 944-5667

Visit us online at: <http://www.edmonton.ca/transportation/neighbourhood-renewal.aspx>

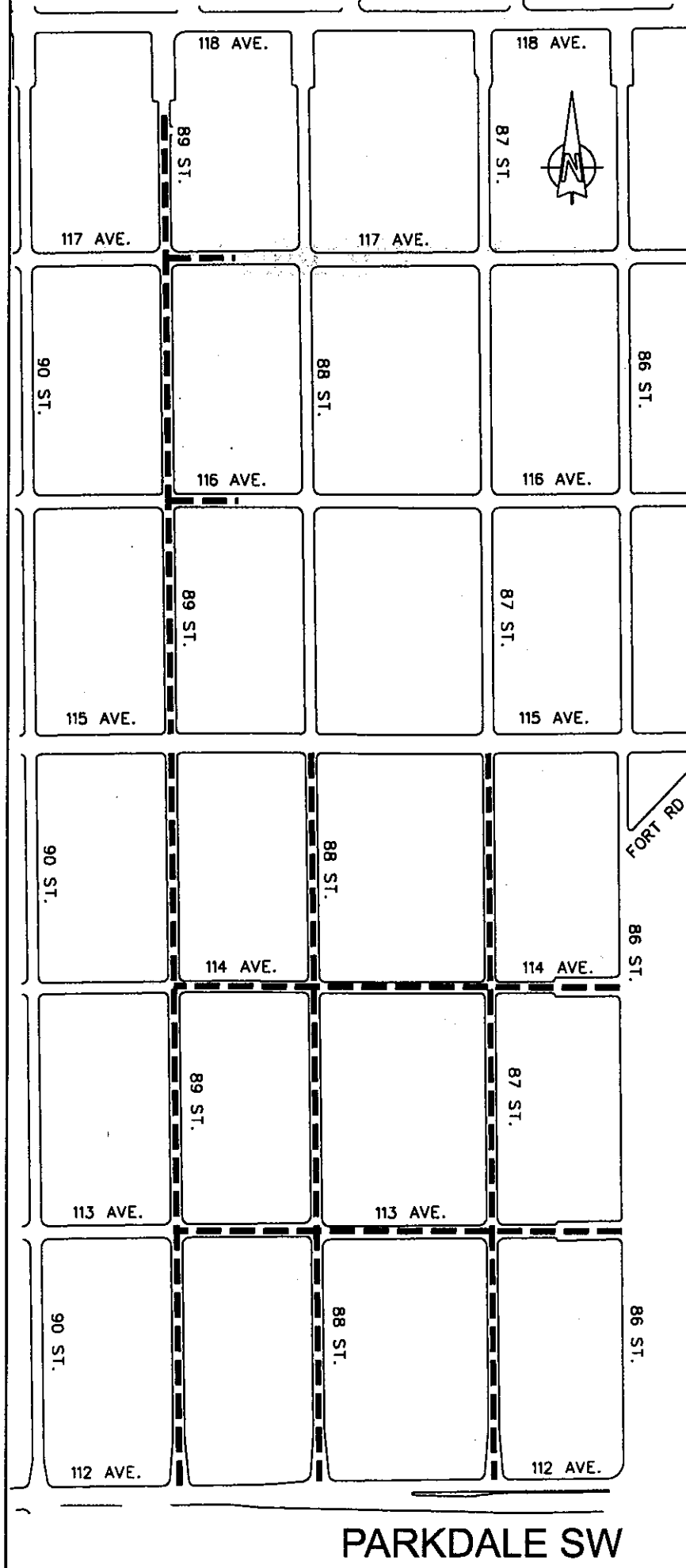

PARKDALE SW