

This plan is the property of the UNDERWRITERS' SURVEY BUREAU, LIMITED. (Unauthorized reproduction prohibited) and is kept in good order, that it is to be used only in connection with Business of Companies, Members of the Canadian Underwriters' Association and is to be returned on request to the UNDERWRITERS' SURVEY BUREAU, LIMITED.

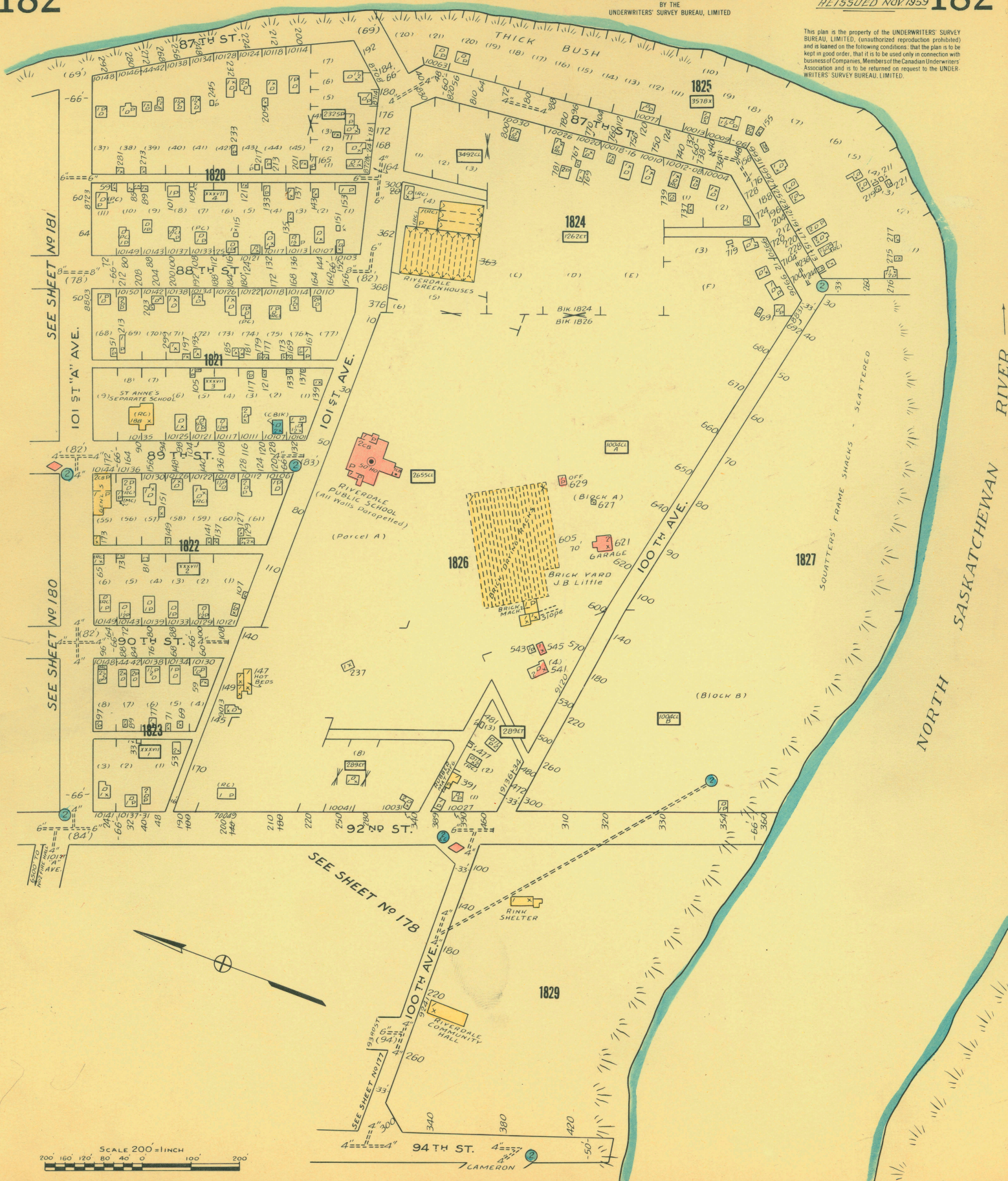

SEE SHEET NO 181

SEE SHEET NO 180

SEE SHEET NO 178

SEE SHEET NO 177

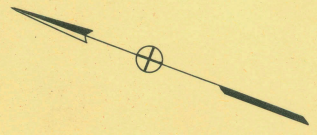
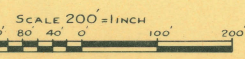

NORTH SASKATCHEWAN RIVER

RIVERDALE COMMUNITY HALL

RIVERDALE PUBLIC SCHOOL (All walls derelict)

1826

1829

1824

1825

1821

1822

1823

1827

101 ST "A" AVE.

101ST AVE.

100TH AVE.

92ND ST.

94TH ST.

CAMERON

SCATTERED
SOULTERS' FRAME SHACKS

BRICK YARD
J.B. LITHE

BIRCH A
GARAGE

PARCEL A

BLOCK B

RIVERDALE GREENHOUSES

BRICKS
MACH.

47 NOT BEDS

RINH SHELTER

OFF 629

621 GARAGE

543

545

570

5120

5120

5120

5120

5120

5120

5120

5120

5120

5120

5120

5120

5120

5120

5120

5120

5120

5120

5120

5120